

Courses & Distances in Perches  
and tenths of a perch.  
Beginning at the South  
East Corner of Tract  
No. 1212

| Stat. | Courses   | Distance |
|-------|-----------|----------|
| 1     | N. 89° W  | 27.6     |
| 2     | N. 56° W  | 22.—     |
| 3     | N. 8° W   | 29.—     |
| 4     | N. 60° W  | 18.—     |
| 5     | N. 53° W  | 23.8     |
| 6     | N. 65½° W | 17.4     |
| 7     | N. 37° W  | 31.—     |
| 8     | N. 4° W   | 25.5     |
| 9     | N. 41° E  | 32.—     |
| 10    | N. 46½° W | 35.—     |
| 11    | N. 63° E  | 50.—     |
| 12    | S. 76¾° E | 9.—      |
| 13    | S. 62° E  | 12.—     |
| 14    | S. 39° E  | 8.—      |
| 15    | S. 17° E  | 11.—     |
| 16    | S. 46½° E | 15.2     |
| 17    | S. 88½° E | 19.—     |
| 18    | S. 54¼° E | 29.—     |
| 19    | S. ¼° W   | 141.—    |

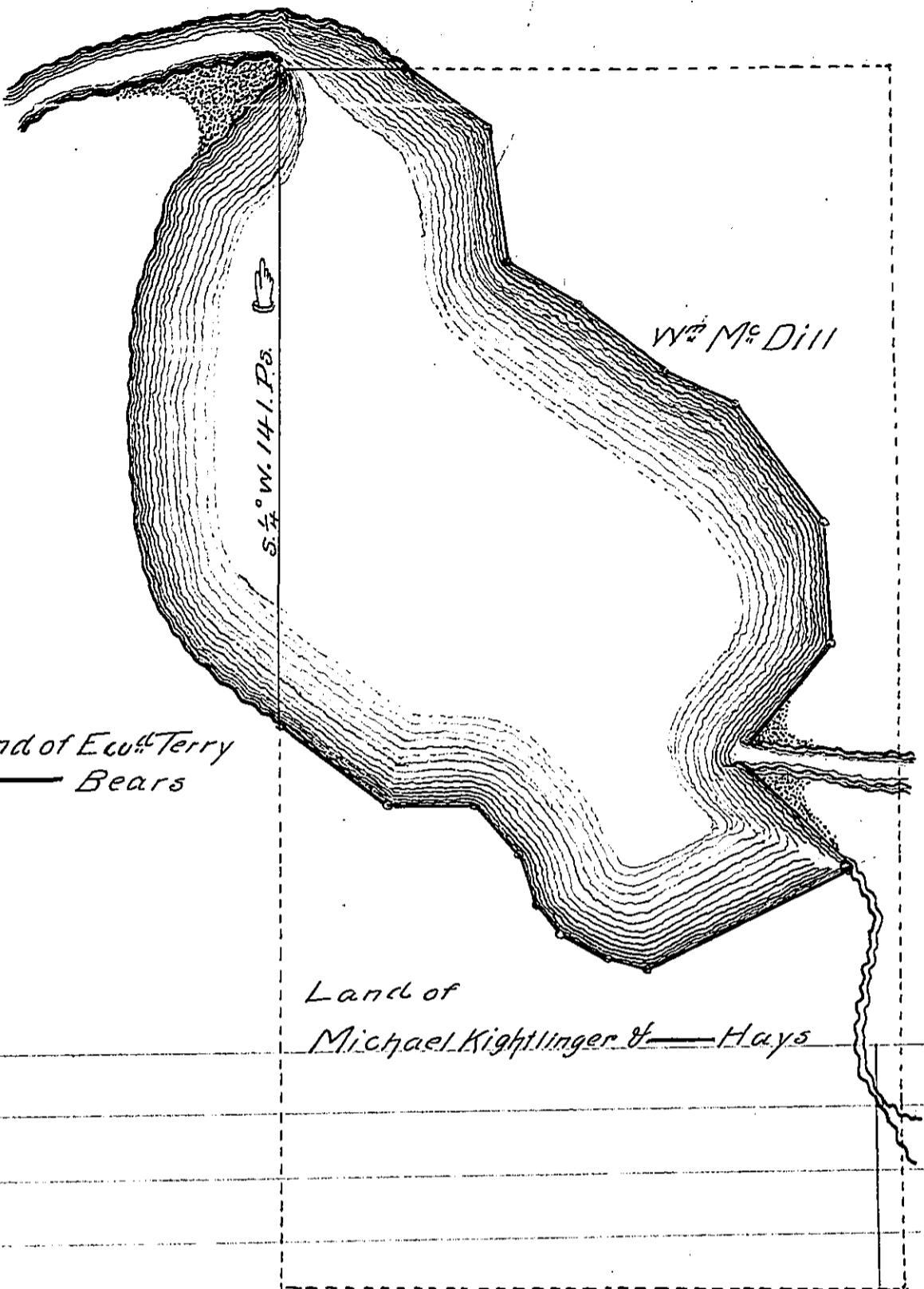

Land of E. Terry  
& Bears

Land of  
Michael Kightlinger & Hays

By Virtue of a warrant dated the fourth day of March 1865

Surveyed the 23<sup>d</sup> day of March A. D. 1865 for S. S. Carrier that portion of  
Sugar Creek Lake described in the above draft or Survey. Situate  
in Wayne Township in the County of Crawford. Containing Ninety  
one acres and three perches and allowance of Six per Cent.

March 27<sup>th</sup> 1865

James Tryon Surveyor for

Crawford County

To Hon. James P. Barr

Surveyor General

IN TESTIMONY that the above is a copy of the original remaining on file in  
the Department of Internal Affairs of Pennsylvania, made  
conformably to an Act of Assembly approved the 16th day of  
February, 1833, I have hereunto set my Hand and caused  
the Seal of said Department to be affixed at Harrisburg,  
this tenth day of June 1904

*Isaac R. Barr*  
Secretary of Internal Affairs.